



HOMER 19" X 19" X 6
1/2" PORCELAIN ENAMEL
ROUND LAVATORY



3002 130 CENTERSET PUNCH, SELF-RIM

DESCRIPTION:

Homer 19" round self-rimming porcelain enamel lavatory with 4" centersets - timeless round shape that goes with any décor - flat mounting surface without soap depressions - accommodates the latest faucet designs - exclusive "contractor friendly" stud and clip mounting assembly for quick and easy installation - weighs only 10 lbs - acid resistant porcelain enameled steel - plastic overflow eliminates pop-offs and rust - installation template printed on shipping carton. This product is compatible or complies with ASME A112.19.1/CSA B45.2 (Standard for Enameled Steel Plumbing Fixtures), WW-P 541 (U.S. Military Federal Specification), HUD-FHA-VA, LEED, and the Buy American Act, as applicable when installed accordingly. Available in white, bone and biscuit colors. Faucets not included. Made in the USA.

Weight: 10 lbs



HOMER 19" X 19" X 6 1/2" PORCELAIN ENAMEL ROUND LAVATORY

Homer Round Lavatory 19" round (brackets w/o soap depressions)

3002 130 Centerset punch, self-rim

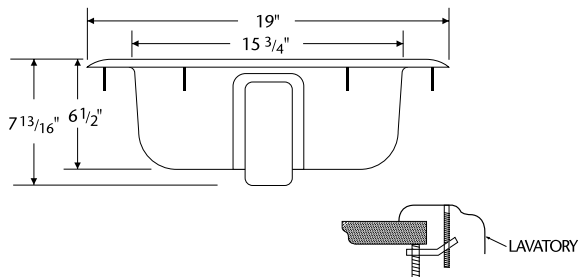
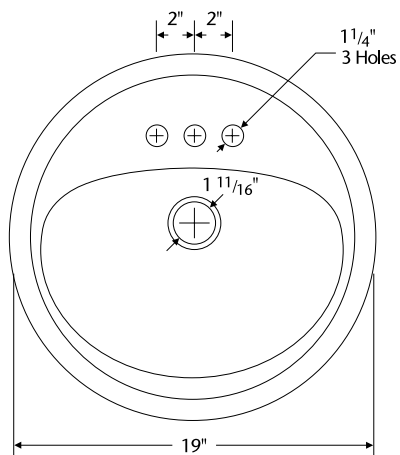

BRIGGS

Complies with:

All fixtures are compatible or comply with ANSI, ASME, CSA, WW-P 541, HUD-FHA-VA, LEED and the "Buy America Act" where applicable when installed accordingly.

Standard Features:

"The affordable alternative to cast iron"
Full length sound deadening pad
Slip resistant bottom
Set it and level it

Made in the USA

All Dimensions +/- 1/8" unless otherwise noted.
Dimensions shown are for reference.
Actual dimensions may vary slightly and should be checked prior to installation



BRIGGS